

FP-A



Technical information

Material

Sleeve

- FP-A
Aluminium

Fixed-point sleeves:

Order code : **FP-A-9,4 x 6**

- Uniform pilot drilling diameter for all pilot holes in a cladding panel
- Very flexible definition of the fixed points: can be done on-site
- Longevity of the fixed-point sleeves as a result of using aluminium

Dimensions: $d = 9,4 \text{ mm}$
 $L = 6,0 \text{ mm}$

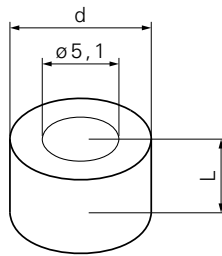

All measures in mm

KEY

VD max. penetration
d thread diameter
KL clamping length

L overall length
t thickness of wood
l_{ef} thread length

FP-A

▲ Aluminium

Application

Sleeve to create a fixed point in a panel hole.

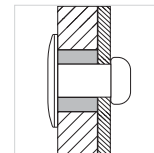

Product code	article number	d x L	PU	notes
FP-A-7,7X12	1467205	7,7X12,0	200	
FP-A-7,9X6	1343278	7,9X6,0	200	
FP-A-8,4X6	1343279	8,4X6,0	200	
FP-A-8,5X3,5	1547651	8,5X3,5	200	
FP-A-8,9X5,9	1547655	8,9X5,9	200	
FP-A-9,4X6	1364621	9,4X6,0	200	
FP-A-9,9X5,7	1485741	9,9X5,7	100	
FP-A-9,9X7,7	1547652	9,9X7,7	200	
FP-A-9,9X9,7	1547653	9,9X9,7	200	
FP-A-9,9X11,7	1547654	9,9X11,7	200	

All measures in mm

KEY**VD** max. penetration**d** thread diameter**KL** clamping length**L** overall length**t** thickness of wood**l_{ef}** thread length